

Powerpoint Face Animation

1. To set up blank page → Click **Layout**  and click **Blank**

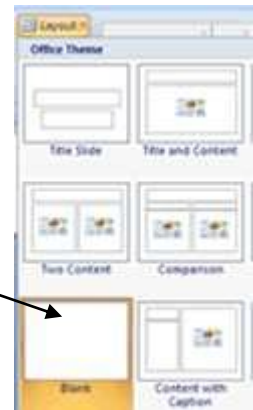

2. Create a **Blank Face** on slide 1

- i. On Home tab click **Shapes** →
- ii. then Click **Oval**
- iii. Click (and hold left mouse button) anywhere on slide
- iv. Drag mouse across slide and let go button
- v. If shape is not correct, press **Delete** and start again

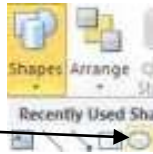

3. Create eyes, nose and mouth using the same **Oval** tool →

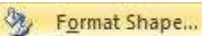
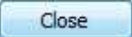
- i. To change shape colour – right click on **shape**
- ii. Click **Format Shape** 
- iii. Click **Fill** or **Line Color** →
- iv. Click **Color button**
- v. Click **Color** (you want)
- vi. Click **Close** 
- vii. Save slideshow as **eyeani**

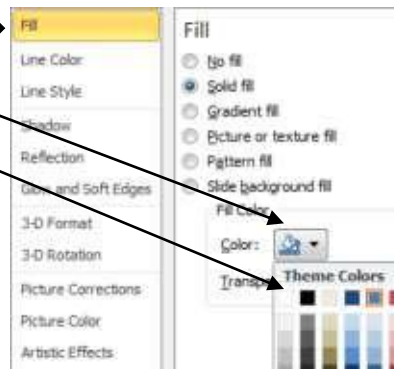

4. Duplicate the first slide →

- i. Right click on **slide** underneath **Slides** tab
- ii. Click **Duplicate Slide**
- iii. **Repeat I and ii** until you have **10** slides

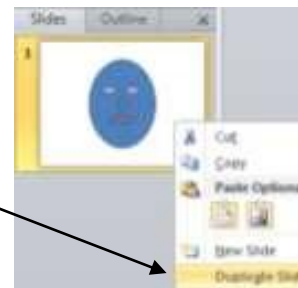

The important feature of a good animation is to make a small change between each slide.

5. Making a small change to each slide, eg. Enlarging one eye.

- i. Click on **eye** shape to select
- ii. Click on **top left 'drag' point**
- iii. Drag **up & left** to increase size of eye
- iv. Make a small increase to this eye on each slide
- v. Save slideshow as **eyeani**

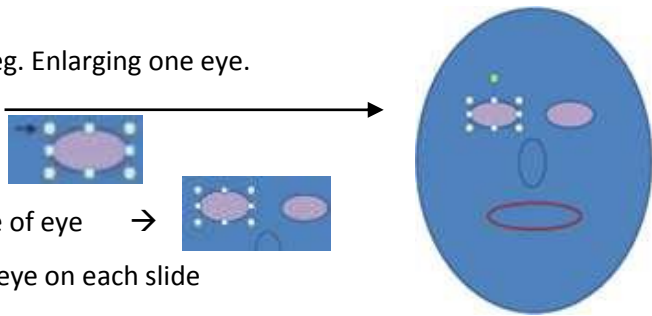

6. Set timings for animation

- i. Click on **Transitions** tab
- ii. Click on **Advance Slide** **After:** and set time to **00:00:50**
- iii. Click **Apply to All**

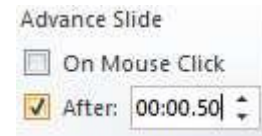

7. View Animation

- i. Click **Slideshow** tab
- ii. Click **From Beginning**



Experiment by changing timings and different features of face.

Task:

Devise an animation that could be used to represent some aspect of Health and Wellbeing.

It could be about the importance of healthy eating, not smoking taking physical exercise or anything that you consider to be relevant to you.

Export to Gif animator

1. Click File
2. Click Save As
3. Click **Save as type:**
4. Click **GIF Graphics Interchange Format**
5. Click Save
6. When prompted to Save every slide, click **Every Slide**

